



Sanichlor CHLORINE TABLETS

Sanichlor tablets are rapid dissolving chlorine tablets. The product supports hygiene effectiveness in food processing areas and the work environment.

Sanichlor tablets are fast acting due to a broad spectrum of biocidal activity. Very efficient product against bacteria, fungi and viruses.

- **Clean** - Microbial hygiene results due to disinfecting effect.
- **Safe** - Improved work safety due to broad-spectrum antimicrobial efficacy.
- **Efficient** - Maximum hygiene level at lowest concentrations.



USE INSTRUCTIONS

1

2

3

4

5 **DILUTION TABLE**

1 TABLET IN	AVAILABLE CHLORINE OF	TYPICAL USERS
25ml	12,000 ppm	Body fluid spills & conditions of heavy soiling
250ml	1,200 ppm	General disinfection
625ml	480 ppm	WC's, drains, sinks
1,25 litres	240 ppm	Food preparation areas
2,0 litres	150 ppm	Baby bottle treatment
2,5 litres	120 ppm	Cloths & mops

6

7

- 1 Check hygiene plan for detailed use information.
- 2 Carefully remove all food and loosen soils from cleaning area.
- 3 Wear protecting gloves and eye / face protection when handling the product.
- 4 Rinse thoroughly with cold water to remove loose soil.
- 5 Prepare disinfection solution as table shown with cold or lukewarm water. Stirring will speed up the tablet dissolution time.
- 6 Completely wipe surface. Leave in contact for at least 5-15 minutes.
- 7 Rinse off surface with fresh clean water.

REMARK:
MAKE UP FRESH SOLUTION EVERY CLEANING BATCH.
AS SOLUTION WILL BLEACH TEXTILES - TAKE CARE NOT TO SPLASH.
AVOID PROLONGED CONTACT WITH METALS.

SPECIAL NOTES / INFORMATION

For professional use only!
Application area: water resistant surfaces, except aluminum and copper.
Do not mix with any other product!
Dispose of packaging only if emptied and closed. Product residues: see Safety Data Sheet.
Active substance: 100 g Sanichlor tablets contain: 50 g Sodiumdichloroisocyanurate.
Use cleaner disinfectant safely. Always read the label and product information before use.
1 tablet contains 500 mg of Sodiumdichloroisocyanurate.

SAFETY INFORMATION
For further information and safety instructions see product label and Safety Data Sheet.

STORAGE CONDITIONS
Keep only in the original container. Store between 0 and 40 °C.

PACK SIZE
6 x 160 tablets (20 blister packs of 8 tablets)



Sanichlor CHLORINE TABLETS

DISINFECTION OF WASHING WATER FOR SALADS, VEGETABLES AND NON-PEELABLE FRUITS



RECOMMENDED USE INSTRUCTIONS

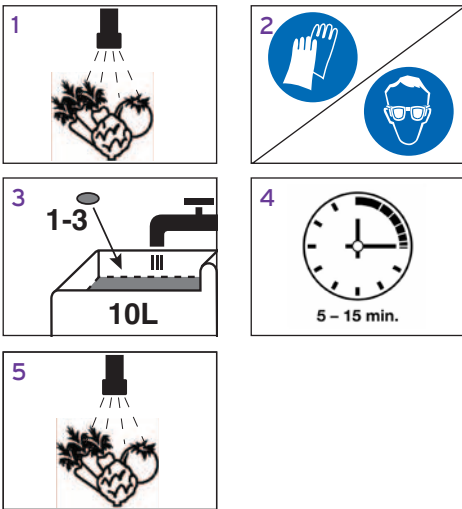

- 1 Remove dirt and debris from vegetable and fruit as much as possible by thoroughly rinsing in cold fresh drinking water.
- 2 Wear protecting gloves and eye / face protection when handling the product.
- 3 Prepare the Sanichlor solution by adding the appropriate number of tablets to the specified quantity of water:

DILUTION TABLE			
Tablets per 10 L water	GIVES AVAILABLE CHLORINE OF	MINIMUM NECESSARY QUANTITY OF CHLORINE	RECOMMENDED CONTACT TIME
1	30 ppm	24 ppm	15 min
2	60 ppm	48 ppm	10 min
3	90 ppm	72 ppm	5 min

- 4 Apply the fresh produce in the use solution with the recommended contact time.
- 5 Always rinse after washing with plenty of cold fresh drinking water. Consume vegetables within a short time period.
Change wash water regularly (recommended after each batch of items) and check for chlorine concentration by using Ecolab test paper.

SPECIAL NOTES / INFORMATION

For professional use only!

Application area: Disinfection of washing water for salads, vegetables and non-peelable fruits.

Do not mix with any other product!
Dispose of packaging only if emptied and closed. Product residues: see Safety Data Sheet.

Active substance: 100 g Sanichlor tablets contain: 50 g Sodiumdichloroisocyanurate. Use cleaner disinfectant safely. Always read the label and product information before use.

1 tablet contains 500 mg of Sodiumdichloroisocyanurate.

SAFETY INFORMATION

For further information and safety instructions see product label and Safety Data Sheet.

STORAGE CONDITIONS

Keep only in the original container. Store between 0 and 40 °C.

PACK SIZE

6 x 160 tablets (20 blister packs of 8 tablets)